



Procurement Office
495 Upper Falls Blvd.
Rochester, NY 14605
WWW.ROCHESTERHOUSING.ORG

July 20, 2022

ADDENDUM #1

To: Potential Bidders

RE: Rochester Housing Authority

Bronson Court Site Install HWT and Furnaces
8 Pages including this cover sheet

The bid opening will be postponed until Thursday, July 28, 2022 at 11:00 am

Acknowledgement:

I have received the above referenced Addendum #1 and have used it in the calculation/preparation of this bid.

Contractor

Without acknowledgement of this addendum your bid may be non-responsive. Please put in your bid submission.

BID ADDENDUM NO. 1

7/19/2022

Rochester Housing Authority
Bronson Court – Furnace and Hot Water Heater Replacement
2285-060

The following Addendum items shall be considered a part of the contract documents prepared by HUNT ENGINEERS, ARCHITECTS, LAND SURVEYORS & LANDSCAPE ARCHITECT, DPC. Bid Document date of 06/08/2022.

Revision to Drawings Issued by this Addendum:

- | | |
|----------------------|--|
| ITEM AD-1-1
AMEND | Refer to M0.1-DEMOLITION – TYPICAL 3 BEDROOM BASEMENT PLAN
Existing panel box shown for clarity. |
| ITEM AD-1-2
AMEND | Refer to M0.2-DEMOLITION – TYPICAL 2 BEDROOM BASEMENT PLAN
Existing panel box shown for clarity. |
| ITEM AD-1-3
AMEND | Refer to M1.1-NEW WORK – TYPICAL 3 BEDROOM BASEMENT PLAN
Addition of Drawing Notes 10, 11, and 12 and existing panel box. |
| ITEM AD-1-4
AMEND | Refer to M1.2-NEW WORK – TYPICAL 2 BEDROOM BASEMENT PLAN
Addition of Drawing Notes 10, 11, and 12 and existing panel box. |

RFI addressed by this Addendum:

RFI 1-1:

Question: “What is the duration of the project?”

Answer: “The duration of the project is 250 days. Time extensions are allowed based upon events outside of contractor’s grasp. Notify RHA with proof of delay from manufacturer/ supplier in writing of time to acquire materials.”

RFI 1-2:

Question: “Will there be venting out the existing glass block, if so is there a detail?”

Answer: “No. The existing vents for the driers in the glass block will be abandoned and removed in a future project. All drier venting should through the rim joists to a;”n #@332 new exterior vent hood.

HUNT ENGINEERS, ARCHITECTS, LAND SURVEYORS & LANDSCAPE ARCHITECT, DPC

ROCHESTER OFFICE
4 COMMERCIAL STREET, SUITE 300
ROCHESTER, NY 14614
TELE: 585.327.7950

HORSEHEADS OFFICE
100 HUNT CENTER
HORSEHEADS, NY 14845
TELE: 607.358.1000

TOWANDA OFFICE
1 ELIZABETH STREET, SUITE 12
TOWANDA, PA 18848
TELE: 570.265.4868

HUNT-EAS.COM

RFI 1-3:

Question: “Can the locations of water heater/ furnace move to allow for proper venting?”

Answer: “Yes, RHA has ordered short style water heaters so there should not be an issue with location of equipment within the basement. The piping should be straight and plumb.”

RFI 1-4:

Question: “How will the units be accessible at the start of each day?”

Answer: “There will be a security guard that will come each morning to allow the contractor to gain access into the building.”

RFI 1-5:

Question: “What work will be done to the existing flues out the roof?”

Answer: “Cap off flues from basement level/ abandon. **Roofing Contractor (under separate project)** to remove existing flues from roof.”

RFI 1-6:

Question: “Who will provide a power circuit and breaker for the new water heater?”

Answer: “RHA will provide a new electrical circuit and breaker for the water heater and will install a GFCI protected outlet in the ceiling in a location above the new water heater. This work will be performed by RHA and be completed before the HVAC contractor starts their work. The new WH draft hood will have a cord that simply plugs into the new RHA supplied outlet.”

RFI 1-7:

Question: “For the furnace condensate drain, the plans say to install a PVC tee on the washing machine drain riser. The basement that I looked at had a copper drain riser?”

Answer: “That observation is correct. Please expect all 37 units to have 1 ½” copper laundry drain riser. The contractor will need to purchase and use a Fernco Proflex part # 3001-150 to adapt from the copper to PVC. Alternately condensate drain can drain to an existing sink.”

RFI 1-8:

Question: “The existing furnaces are powered by a fused switch. The fuse holder is old, and the new furnaces do not require an external fuse. Please describe the way the power will be switched for the new furnace?”

Answer: “The contractor to provide installation of a new GFCI protected switch (GFCI protected switch provided by RHA). Wire and installation accessories to control the new furnace will be required to be provided by the contractor.

RFI 1-9:

Question: “May we use a “pro-press” to connect the copper pipe on the water heater?”

Answer: “Yes.”

RFI 1-10:

Question: “During the walk through, I saw a gas meter pressure regulator vent located in an area where the furnace is to be vented. Per RG&E the furnace vent and the regulator vent need separation?”

Answer: “That is correct. The contractor should bid on and install the project as specified. If we find a gas regulator vent too close to the (new) furnace vents, RHA will take full responsibility to move and relocate the gas regulator vents per code.”

RFI 1-11:

Question: “Why is the venting 3"pvc on the water heater when the manufacturer provides a new 2"outlet option?”

Answer: “The contractor to provide 2” PVC venting.

End of Addendum 1

ACKNOWLEDGMENT OF RECEIPT BY:

LEGAL NAME OF BIDDER: _____

BY (Signature & Title): _____

DATE: _____

THIS PAGE SHALL BE ATTACHED TO AND SUBMITTED WITH THE BID PROPOSAL.

DEMOLITION NOTES:

- D1. REMOVE FURNACE IN ITS ENTIRETY. DISCONNECT SUPPLY AND RETURN DUCTWORK, GAS PIPING, AND FLUE TO ALLOW FOR INSTALLATION OF NEW FURNACE. CAP FLUE AND ABANDON IN PLACE. DISCONNECT ELECTRICAL FEED.
- D2. REMOVE WATER HEATER IN ITS ENTIRETY. DISCONNECT CW, HW, GAS, AND FLUE TO ALLOW FOR INSTALLATION OF NEW WATER HEATER. DISCONNECT ELECTRICAL FEED.

GENERAL NOTES:

- 1. REFER TO DRAWING G1.1 FOR GENERAL NOTES.

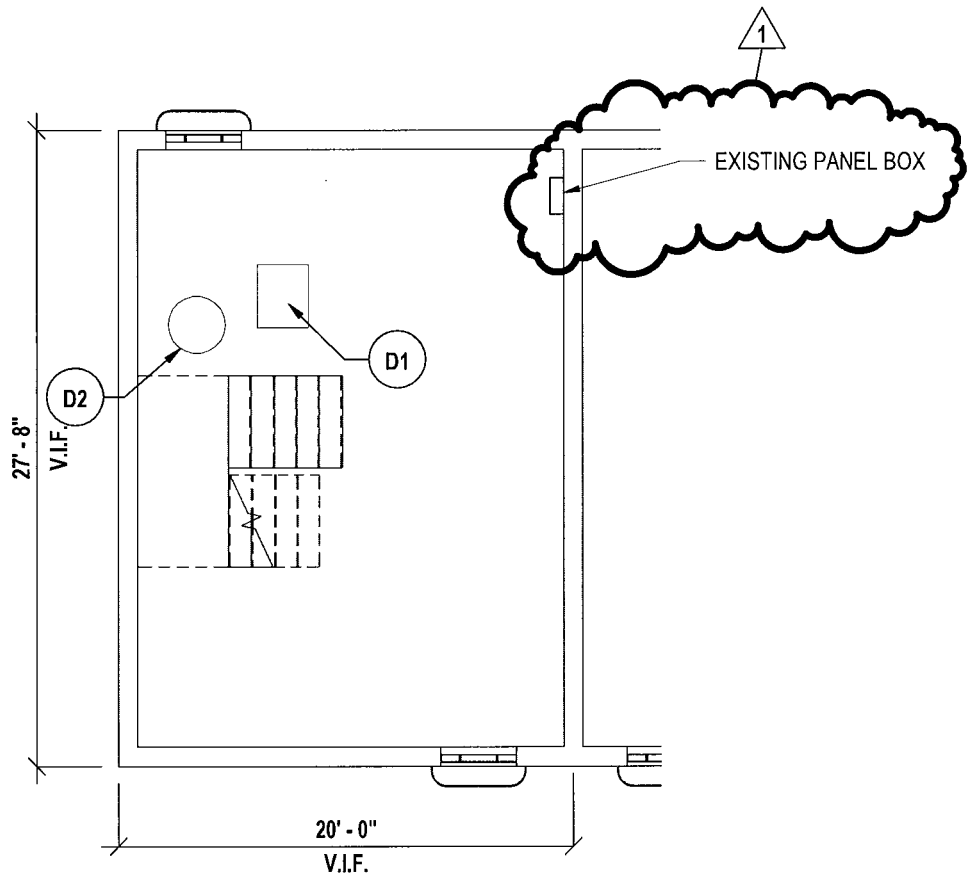

1 **DEMOLITION - TYPICAL 3 BEDROOM BASEMENT PLAN**
 1/8" = 1'-0"

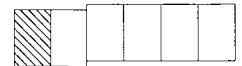

KEY:

#	DATE	DESCRIPTION OF REVISION	BY
1	07/19/2022	ADDENDUM 01	AJG

DEMOLITION - TYPICAL 3 BEDROOM BASEMENT PLAN
 BRONSON COURT: WATER HEATER AND FURNACE UPGRADE
 ROCHESTER HOUSING AUTHORITY
 90 SAMUEL McCREE WAY, ROCHESTER, NY, 14608

COPYRIGHT: 2022

HUNT ENGINEERS | ARCHITECTS | SURVEYORS
 ROCHESTER, NY 585 - 327 - 7949 HORSEHEADS, NY 607 - 358 - 1000
 TOWANDA, PA 570 - 265 - 4868

M0.1

DATE:
04/01/2022

PROJECT NO:
2285-060

DEMOLITION NOTES:

- D1. REMOVE FURNACE IN ITS ENTIRETY. DISCONNECT SUPPLY AND RETURN DUCTWORK, GAS PIPING, AND FLUE TO ALLOW FOR INSTALLATION OF NEW FURNACE. CAP FLUE AND ABANDON IN PLACE. DISCONNECT ELECTRICAL FEED.
- D2. REMOVE WATER HEATER IN ITS ENTIRETY. DISCONNECT CW, HW, GAS, AND FLUE TO ALLOW FOR INSTALLATION OF NEW WATER HEATER. DISCONNECT ELECTRICAL FEED.

GENERAL NOTES:

- 1. REFER TO DRAWING G1.1 FOR GENERAL NOTES.

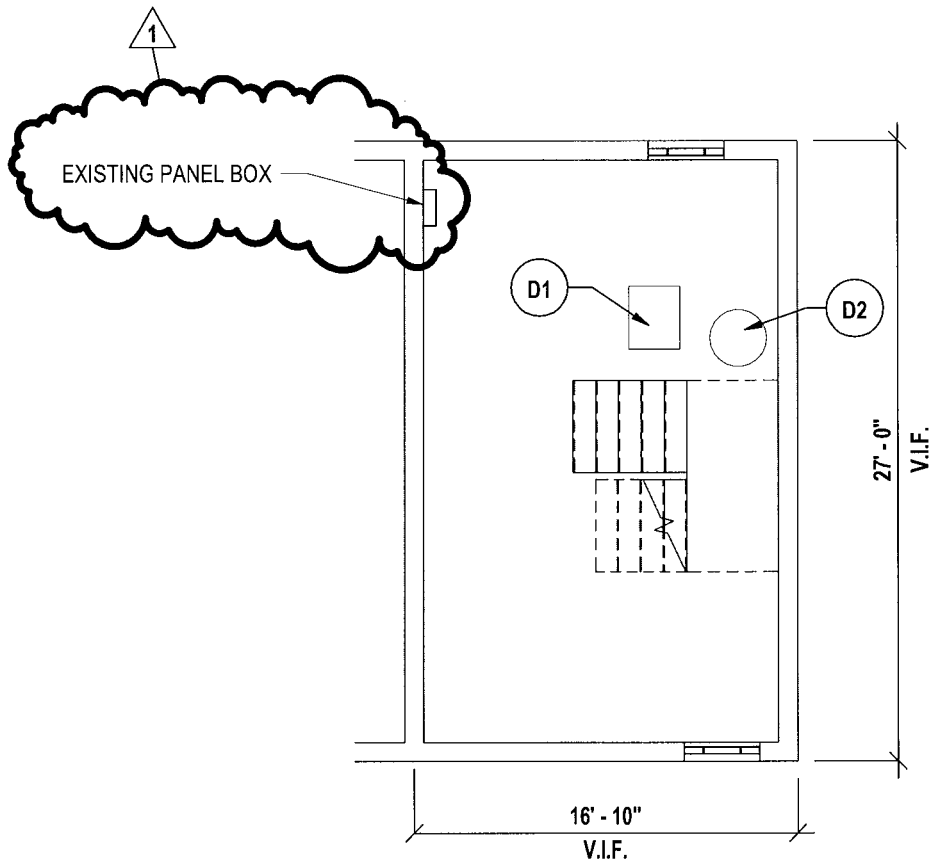

1 DEMOLITION - TYPICAL 2 BEDROOM BASEMENT PLAN
 1/8" = 1'-0"



KEY:

#	DATE	DESCRIPTION OF REVISION	BY
1	07/19/2022	ADDENDUM 01	AJG

DEMOLITION - TYPICAL 2 BEDROOM BASEMENT PLAN
BRONSON COURT: WATER HEATER AND FURNACE UPGRADE
ROCHESTER HOUSING AUTHORITY
 90 SAMUEL McCREE WAY, ROCHESTER, NY, 14608

COPYRIGHT 2022

HUNT ENGINEERS | ARCHITECTS | SURVEYORS
 ROCHESTER, NY 585 - 327 - 7949 HORSEHEADS, NY 607 - 358 - 1000
 TOWANDA, PA 570 - 265 - 4868

M0.2

DATE:
04/01/2022

PROJECT NO:
2285-060

DRAWING NOTES:

1. EXTEND AND RECONNECT CW, HW, GAS, AND ELECTRIC.
2. EXTEND AND RECONNECT SUPPLY AND RETURN DUCTWORK, GAS, PIPING, AND ELECTRIC.
3. INSTALL WH-1 – WATER HEATER AS FURNISHED BY OWNER/RHA. BASIS OF DESIGN, RHEEM PROG40S-36N RH67PV. FAHRENHEIT RISE PROVIDE T+P RELIEF VALVES + DRAIN PER MANUFACTURES RECOMMENDATIONS.
4. INSTALL FURN-1 – FURNACE AS FURNISHED BY OWNER/RHA. BASIS OF DESIGN, RHEEM R92TA0601317MSA WITH RXGC-B21 BASE; RHEEM 9RA7016 RETURN BOOT, THERMOSTAT BASIS OF DESIGN, HONEYWELL TH511001006 FOCUS PRO NON-PROGRAMMABLE, 1H/ 1C. FILTER TO BE 1" FIBERGLASS, KOCM DISPOSABLE PANEL FILTER OR APPROVED EQUAL.
5. PROVIDE NEW 2" SCHEDULE 40 PVC EXHAUST AND INTAKE. SEE KEY PLANS & EXTERIOR ELEVATIONS FOR APPROXIMATE LOCATIONS.
6. PROVIDE NEW 2" SCHEDULE 40 PVC EXHAUST AND INTAKE. SEE KEY PLANS & EXTERIOR ELEVATIONS FOR APPROXIMATE LOCATIONS.
7. PROVIDE INSTALLATION OF NEW FURNACE CONDENSATE PUMP AS FURNISHED BY OWNER/RHA. EXTEND PIPING TO FROM CONDENSATE PUMP INTO EXISTING WASHER STANDPIPE. INSTALLATION OF NEW PVC PIPING TO BE ROUTED NEATLY ALONG FIRST FLOOR JOISTS AND STRUCTURE.
8. PROVIDE NEW 4" DRIER EXHAUST PER DETAIL 1/M1.3 OR 2/M1.3. SEE KEY PLANS & EXTERIOR ELEVATIONS FOR APPROXIMATE LOCATIONS.
9. BASIS OF DESIGN, THERMOSTAT HONEYWELL TH511001006 FOCUS PRO NON-PROGRAMMABLE. PROVIDE REPLACEMENT OF EXISTING THERMOSTAT AS FURNISHED BY RHA/ OWNER WITH NEW IN THE FIRST FLOOR LIVING AREA CONNECT TO EXG. FURNACE CIRCUITRY.

10. CONNECT WH-1 TO NEW OWNER INSTALLED GFCI PROTECTED OUTLET.

11. NEWLY INSTALLED GFCI PROTECTED OUTLET PROVIDED BY RHA/ OWNER INSTALLED OVER WH-1.

12. PROVIDE INSTALLATION OF OWNER FURNISHED GFCI PROTECTED OUTLET/ SWITCH TO FURN-1 AND CONDENSATE PUMP.

GENERAL NOTES:

1. REFER TO DRAWING G1.1 FOR GENERAL NOTES.

NOTE:

1. NEW EXHAUST AND INTAKE LOCATIONS ARE SHOWN FOR REFERENCE ONLY AND MAY NOT REFLECT THE ACTUAL CONFIGURATIONS. SEE KEYPLAN & EXTERIOR ELEVATIONS FOR APPROXIMATE LOCATION.



KEY:

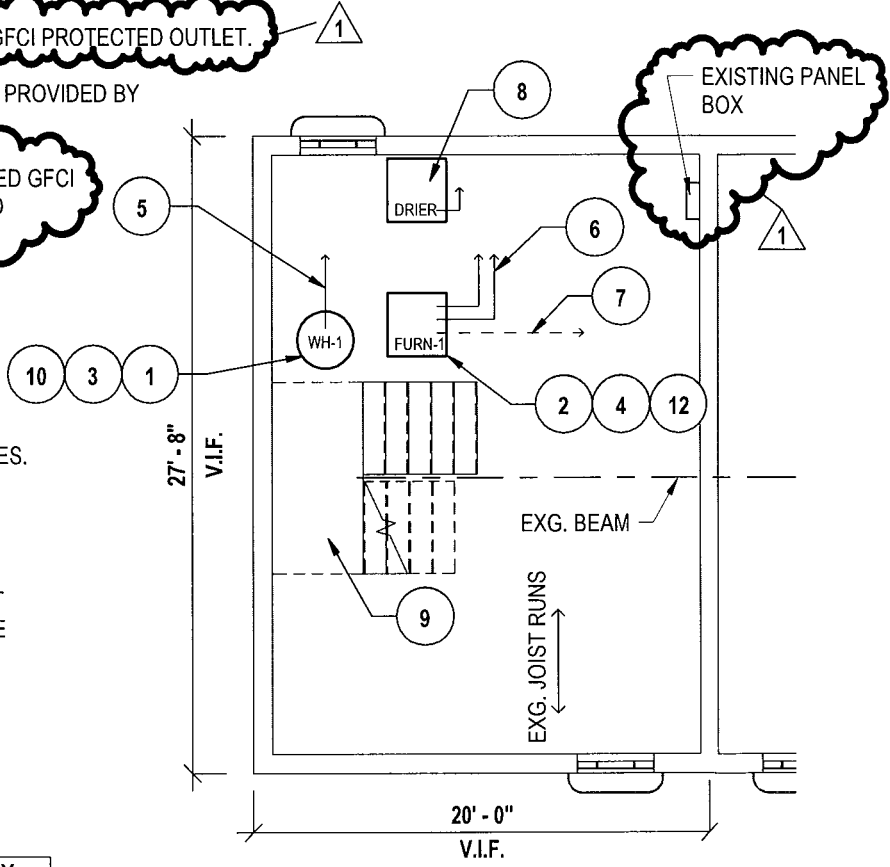

1 NEW WORK - TYPICAL 3 BEDROOM BASEMENT PLAN
1/8" = 1'-0"

#	DATE	DESCRIPTION OF REVISION	BY
1	07/19/2022	ADDENDUM 01	AJG

NEW WORK - TYPICAL 3 BEDROOM BASEMENT PLAN
BRONSON COURT: WATER HEATER AND FURNACE UPGRADE
ROCHESTER HOUSING AUTHORITY
 90 SAMUEL McCREE WAY, ROCHESTER, NY, 14608

COPYRIGHT: 2022

HUNT ENGINEERS | ARCHITECTS | SURVEYORS
 ROCHESTER, NY 585 - 327 - 7949 HORSEHEADS, NY 607 - 358 - 1000
 TOWANDA, PA 570 - 265 - 4868

M1.1

DATE:
04/01/2022
 PROJECT NO:
2285-060

DRAWING NOTES:

1. EXTEND AND RECONNECT CW, HW, GAS, AND ELECTRIC.
2. EXTEND AND RECONNECT SUPPLY AND RETURN DUCTWORK, GAS, PIPING, AND ELECTRIC.
3. INSTALL WH-1 – WATER HEATER AS FURNISHED BY OWNER/RHA. BASIS OF DESIGN, RHEEM PROG40S-36N RH67PV. FAHRENHEIT RISE PROVIDE T+P RELIEF VALVES + DRAIN PER MANUFACTURES RECOMMENDATIONS.
4. INSTALL FURN-1 – FURNACE AS FURNISHED BY OWNER/RHA. BASIS OF DESIGN, RHEEM R92TA0601317MSA WITH RXGC-B21 BASE; RHEEM 9RA7016 RETURN BOOT, THERMOSTAT BASIS OF DESIGN, HONEYWELL TH511001006 FOCUS PRO NON-PROGRAMMABLE, 1H/ 1C. FILTER TO BE 1" FIBERGLASS, KOCM DISPOSABLE PANEL FILTER OR APPROVED EQUAL.
5. PROVIDE NEW 2" SCHEDULE 40 PVC EXHAUST AND INTAKE. SEE KEY PLANS & EXTERIOR ELEVATIONS FOR APPROXIMATE LOCATIONS.
6. PROVIDE NEW 2" SCHEDULE 40 PVC EXHAUST AND INTAKE. SEE KEY PLANS & EXTERIOR ELEVATIONS FOR APPROXIMATE LOCATIONS.
7. PROVIDE INSTALLATION OF NEW FURNACE CONDENSATE PUMP AS FURNISHED BY OWNER/RHA. EXTEND PIPING TO FROM CONDENSATE PUMP INTO EXISTING WASHER STANDPIPE. INSTALLATION OF NEW PVC PIPING TO BE ROUTED NEATLY ALONG FIRST FLOOR JOISTS AND STRUCTURE.
8. PROVIDE NEW 4" DRIER EXHAUST PER DETAIL 1/M1.3 OR 2/M1.3. SEE KEY PLANS & EXTERIOR ELEVATIONS FOR APPROXIMATE LOCATIONS.
9. BASIS OF DESIGN, THERMOSTAT HONEYWELL TH511001006 FOCUS PRO NON-PROGRAMMABLE. PROVIDE REPLACEMENT OF EXISTING THERMOSTAT AS FURNISHED BY RHA/ OWNER WITH NEW IN THE FIRST FLOOR LIVING AREA CONNECT TO EXG. FURNACE CIRCUITRY.

10. CONNECT WH-1 TO NEW OWNER INSTALLED GFCI PROTECTED OUTLET.

11. NEWLY INSTALLED GFCI PROTECTED OUTLET PROVIDED BY RHA/ OWNER INSTALLED OVER WH-1.

12. PROVIDE INSTALLATION OF OWNER FURNISHED GFCI PROTECTED OUTLET/ SWITCH TO FURN-1 AND CONDENSATE PUMP.

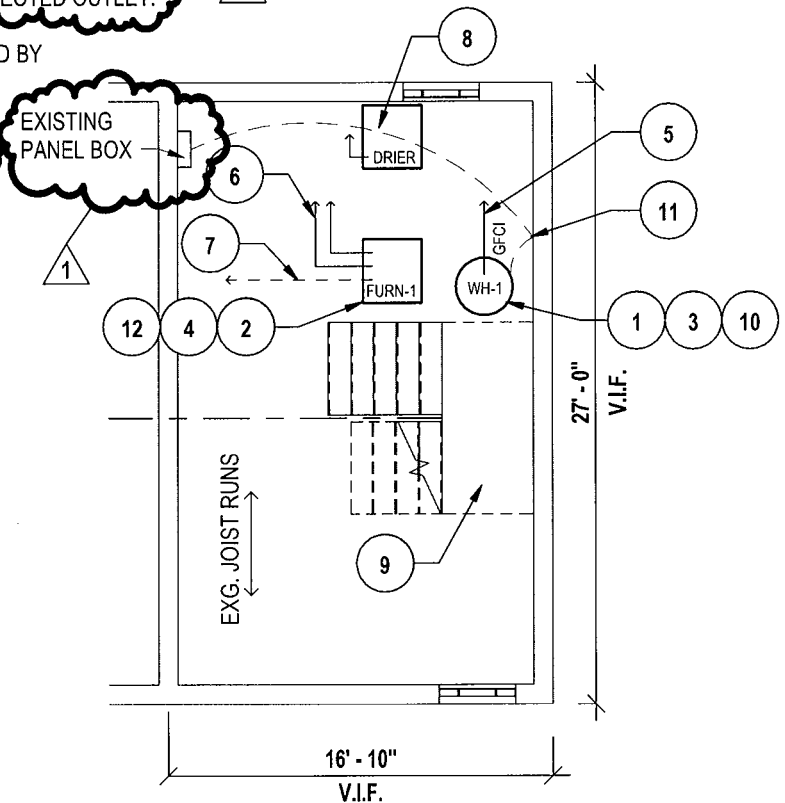

GENERAL NOTES:

1. REFER TO DRAWING G1.1 FOR GENERAL NOTES.

NOTE:

1. NEW EXHAUST AND INTAKE LOCATIONS ARE SHOWN FOR REFERENCE ONLY AND MAY NOT REFLECT THE ACTUAL CONFIGURATIONS. SEE KEYPLAN & EXTERIOR ELEVATIONS FOR APPROXIMATE LOCATION.



KEY:

#	DATE	DESCRIPTION OF REVISION	BY
1	07/19/2022	ADDENDUM 01	AJG

1 NEW WORK - TYPICAL 2 BEDROOM BASEMENT PLAN
1/8" = 1'-0"

NEW WORK - TYPICAL 2 BEDROOM BASEMENT PLAN
BRONSON COURT: WATER HEATER AND FURNACE UPGRADE
ROCHESTER HOUSING AUTHORITY
 90 SAMUEL McCREE WAY, ROCHESTER, NY, 14608

HUNT ENGINEERS | ARCHITECTS | SURVEYORS
 ROCHESTER, NY 585 - 327 - 7949 HORSEHEADS, NY 607 - 358 - 1000
 TOWANDA, PA 570 - 265 - 4868

M1.2
 DATE:
 04/01/2022
 PROJECT NO:
 2285-060